

## venue specification - depot



Our Depot venue is a unique creative space ideal for exhibitions, events, workshops, seminars and talks. Part of Gayfield Creative Spaces, located in central Edinburgh, it is close to the tram, rail and bus termini. Depot has a separate street level entrance, accessible toilet and access to a small basement kitchen area. It can be hired individually or in combination with our other creative spaces.

### Specification

Floor space:	60m <sup>2</sup>
Dimensions:	width - 6.5m tapering to 4.7m wide depth - 10m height - 5.2m
Capacity:	60 theatre style, 120 reception
Facilities:	high speed Wi-Fi internet connection accessible toilet (4.5m <sup>2</sup> ) access to basement kitchen area 4 roof windows provide natural light, pendant lights gantry and roof beams for additional lighting (access ladder available)
Additional information:	full-length concertina doors allow open access to depot black theatre curtain available to cover red concertina doors variety of exhibition furniture and equipment available for events there are also access steps to our other creative spaces we offer additional support and marketing for event organisers

Dimensions

Floor Plan

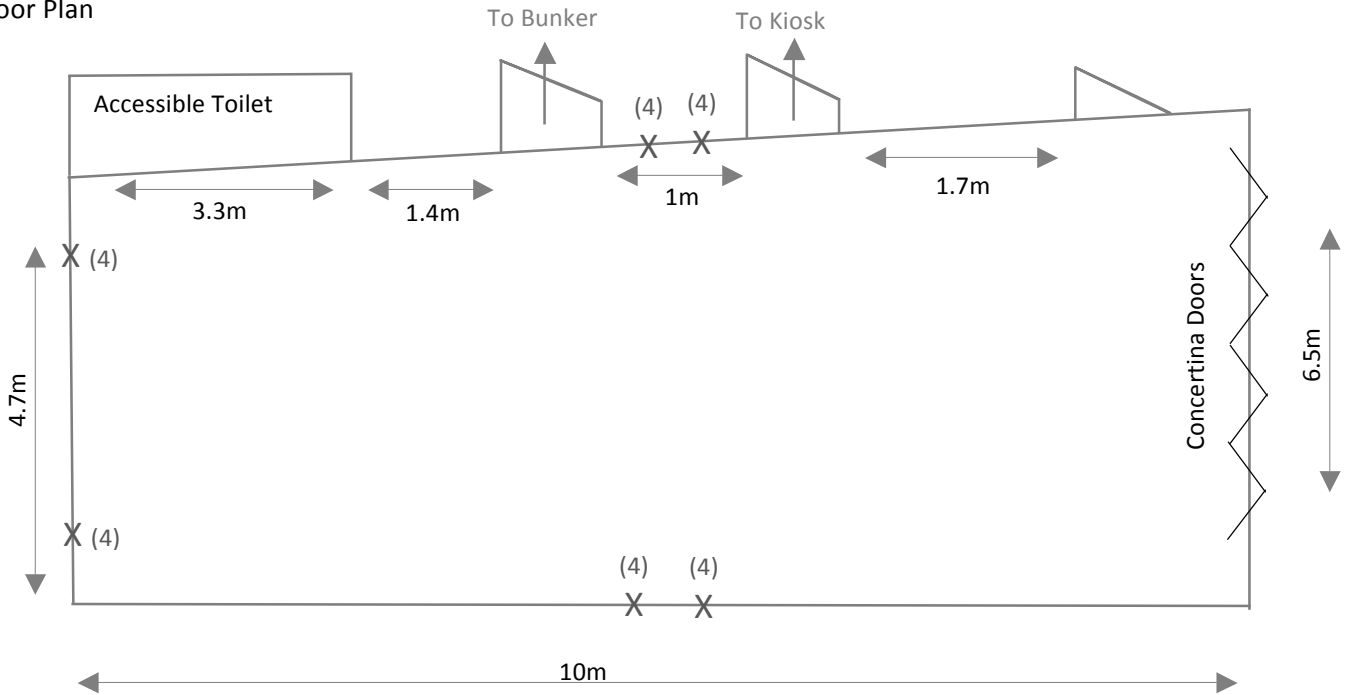

X – plugs (no. of sockets)

Please Note: All dimensions are approximate and should be confirmed in the venue prior to your event. Please have a look at our events archive for examples of this venue in use.

G3\_VS(Jan2016)

gayfield creative spaces / 11 gayfield square / Edinburgh / eh1 3nt a hub for collaboration in central Edinburgh

contact us: [info@gayfield.co.uk](mailto:info@gayfield.co.uk)

follow us on twitter: [@gayfieldsq](https://twitter.com/gayfieldsq)

like us on facebook: [@gayfieldsq](https://www.facebook.com/gayfieldsq)